



## Assignment 1 Site Design Paper

Megan Fisher



### 1. Overview of Project

The Florida multi-purpose agri-business plan is a new development in Anthony Florida on 50 acres of land consisting of 4 parcels that were combined. The main feature of the development is a 2500 square foot Bardonimum (Barndo) that will be used for various events, like short-term summer camps, weddings, conferences, etc. An 500 square foot open-air barn will also be featured near the vineyard and the greenhouse. The green house will also have a dining room inside. An airstream is also featured on the plans. The development will also have walking trails with exercise equipment set up throughout the trails. Set up along the trails will be 4 cottages, featuring 2 bedrooms, 2 baths, and a kitchen. An outdoor in-pool and hot tub is set up near the Barndo. Due to Anthony Florida being in the agricultural region, a cow pasture, a horserink, a small petting zoo and farmer's market building have been included. The cow pasture is in front of the barn. Gardens for crops to be sold at the market and used in the bardo have also been included in the development. A Japanese garden with 30 people capacity with areas for meditation and aerobics and a coy-pond/lake with a boathouse has been included and set up near a yoga tent. Parking for the development has been included near.



Figure 1: Site Map of the four parcels



Figure 2: Main entrance

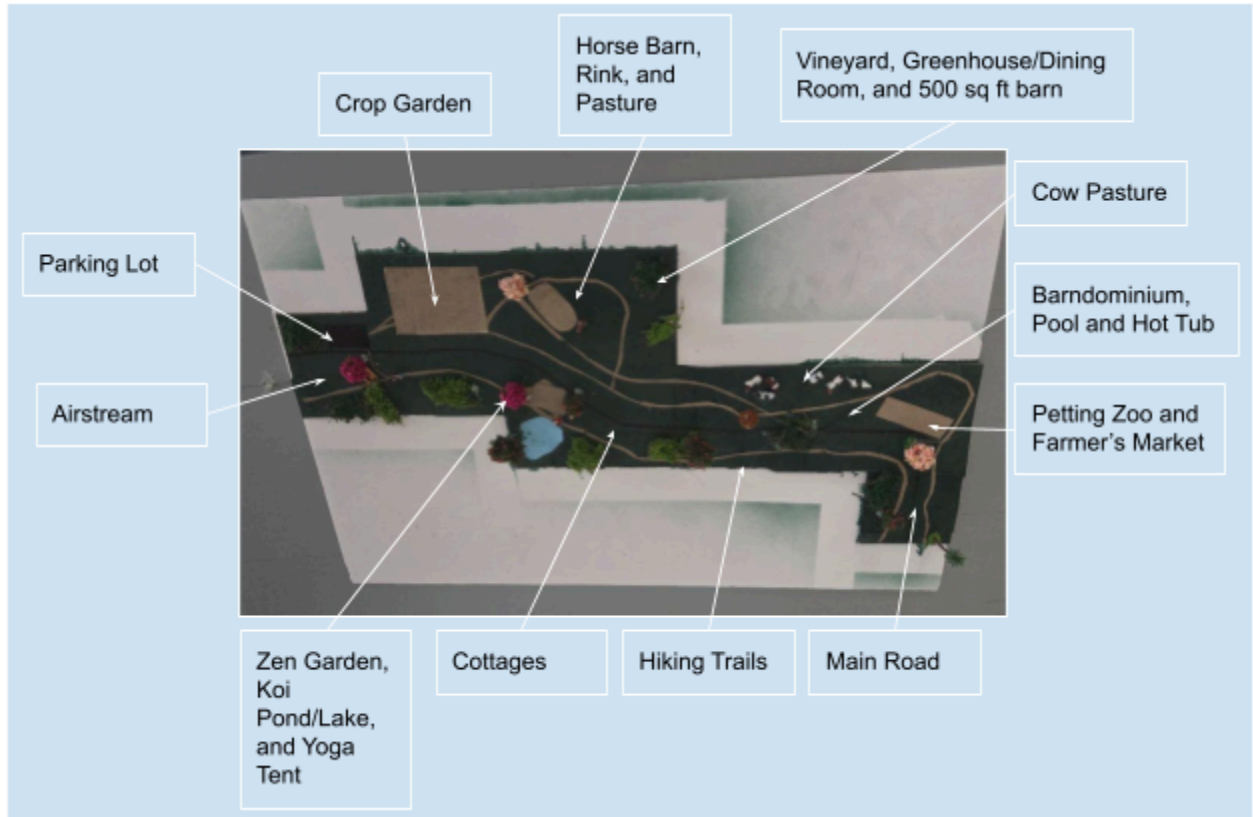

Figure 3: Overview of Development

## 2. Aerial View of Project



Figure 4: Aerial View of the Development Site



The model is in a 1 inch equals 90 foot scale. The black lines on the model represent the road that cars and golf carts will drive on. At the bottom of the development is a parking lot set up off the road. The brown lines represent the hiking trails. There are multiple different trails that span over the whole extent of the development to provide guests with access to all aspects of the development. The blue in the bottom right corner represents the koi pond or lake that fits across from the Japanese zen garden. The zen garden is an organic shape to encourage meditation and outdoor aerobics. In the bottom left corner of the development is the organic garden for crops to be grown. Some of the trails go through the garden so that guests can help pick crops or just experience the agriculture. Just above the garden is the horse rink for the horses along with an upscale horse barn and 27,000 square feet of pasture for the four horses. In the top left corner of the model is the petting zoo and farmer's market to sell the crops from the garden. It is situated off the road so that people, who might not be guests, can easily access the market and petting zoo.

### 3. Description of Models

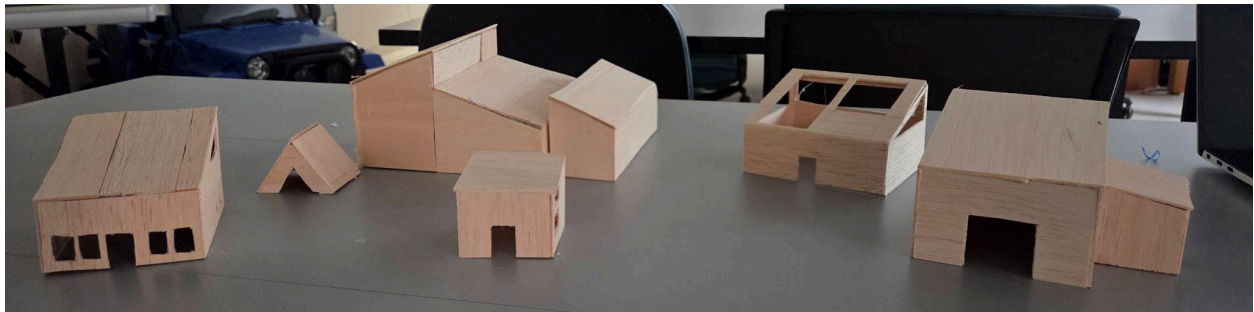

Figure 5: View of All Models

These models are in a 1/8th of an inch equal 1 foot scale. The left most building in the picture is the model of the cottage. The cottage will feature two bedrooms, two baths, a kitchen and a living room and is 672 square feet. The living room and kitchen will be at the front of the cottage and the bedrooms and the baths will be in the back. To the right of the cottage is the yoga tent which will be near the Japanese zen garden and lake. The building next to that is the Barndo which is 2500 square feet. This is the only building that was not created by my own design because it came from the developers. The model in front of the Barndo is the boat house which is 256 square feet. The boat house will be placed near the koi lake so that any water toys or boats can be housed there. The model to the right of the Barndo is the green house/dining room, which is 896 square feet. The green house has large sky lights to allow growth of plants but also to be enjoyed by guests. The only part of the building that does not have a sky light is where the kitchen is slated to go. The right most building is the upscale horse barn, which is 1088 square feet. The barn was designed to comfortably accommodate the horse along with having a loft for hay and other supplies. On the right side of the barn is a place for employees to put their stuff, sleep, and relax as well as having a place for other supplies for the horses. Each of the buildings are modeled off of the style of the Barndo. The design of the models was made this way in order for the aesthetics of each of the builds to match.

# Appendices

## Appendix 1: Development Model



Figure 6: Aerial View of Parking Lot, Crop Garden, Horse Rink and Pasture, and Japanese Zen Garden, and Koi Pond,, Vineyard and 500 square foot barn, and Various Hiking Trails and Road





Figure 7: Aerial View of Cow Pasture, Petting Zoo and Farmer's Market, Pool and Tub, Various Hiking Trails and Road



Figure 8: Closer View of Zen Garden and Koi Pond



Figure 9: Closer View of Horse Rink and Pasture, Vineyard and 500 square foot barn



Figure 10: Closer View of Cow Pasture, Pool and Hot Tub, Petting Zoo and Farmer's Market



## Appendix 2: Cottage

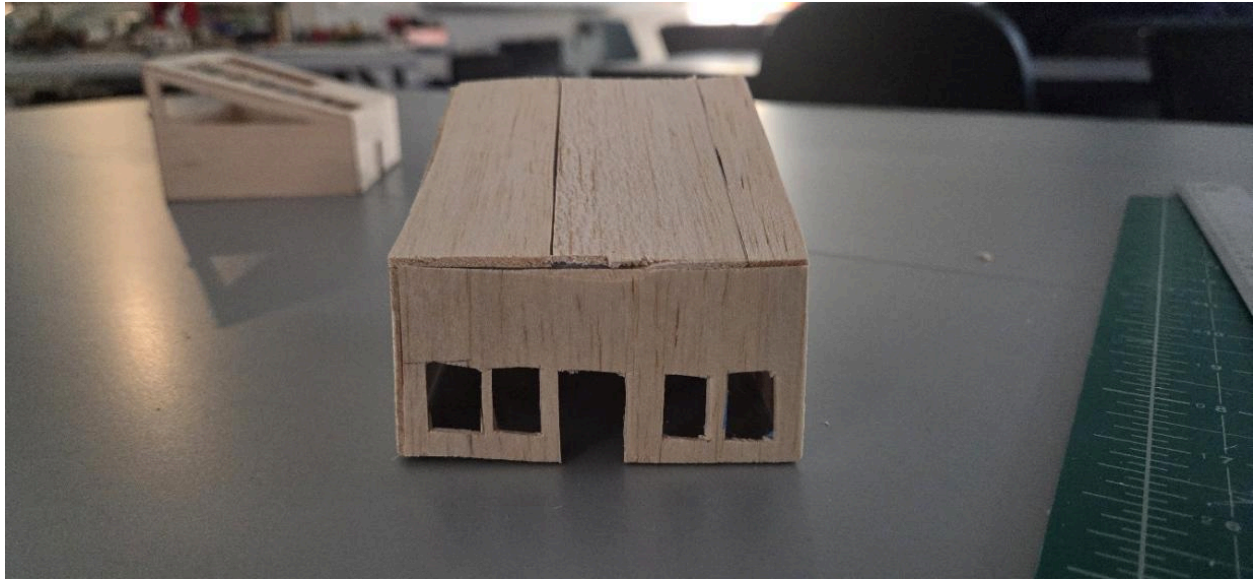

Figure 11: Front View of Cottage



Figure 12: Right Side View of Cottage

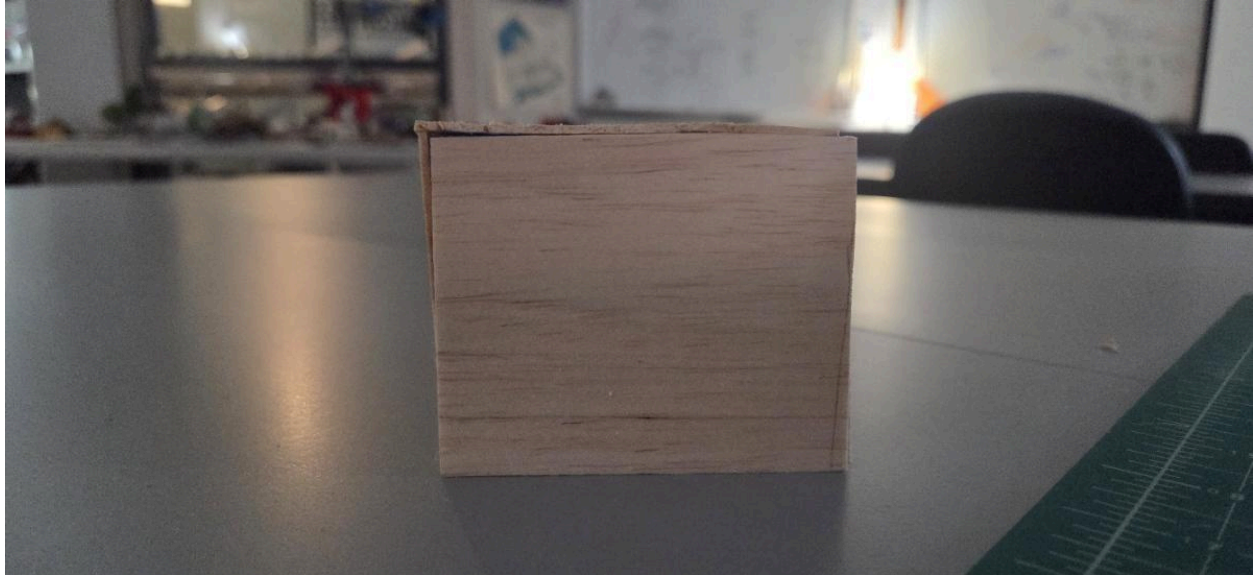

Figure 13: Rear View of Cottage

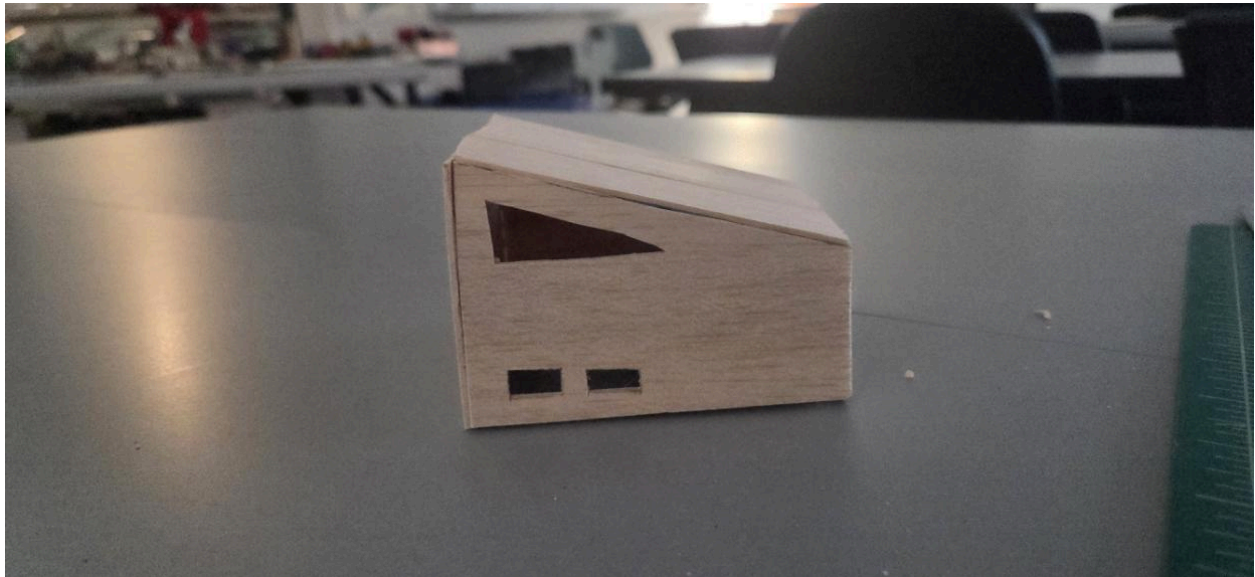

Figure 14: Left Side View of Cottage



### Appendix 3: Yoga Tent

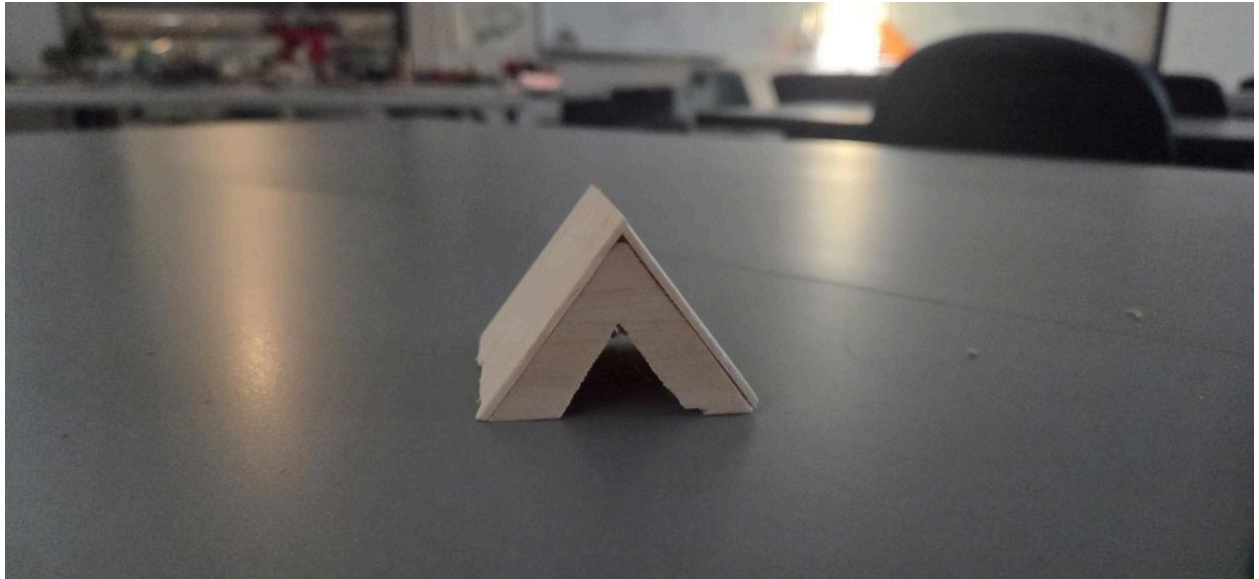

Figure 15: Front View of Yoga Tent

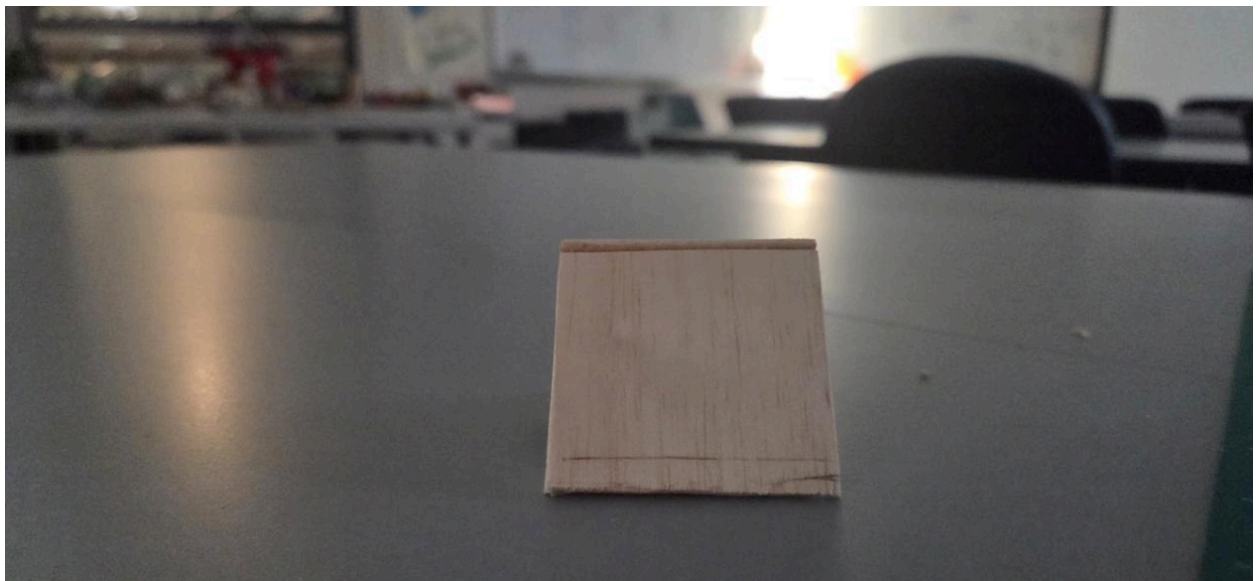

Figure 16: Right Side View of Yoga Tent



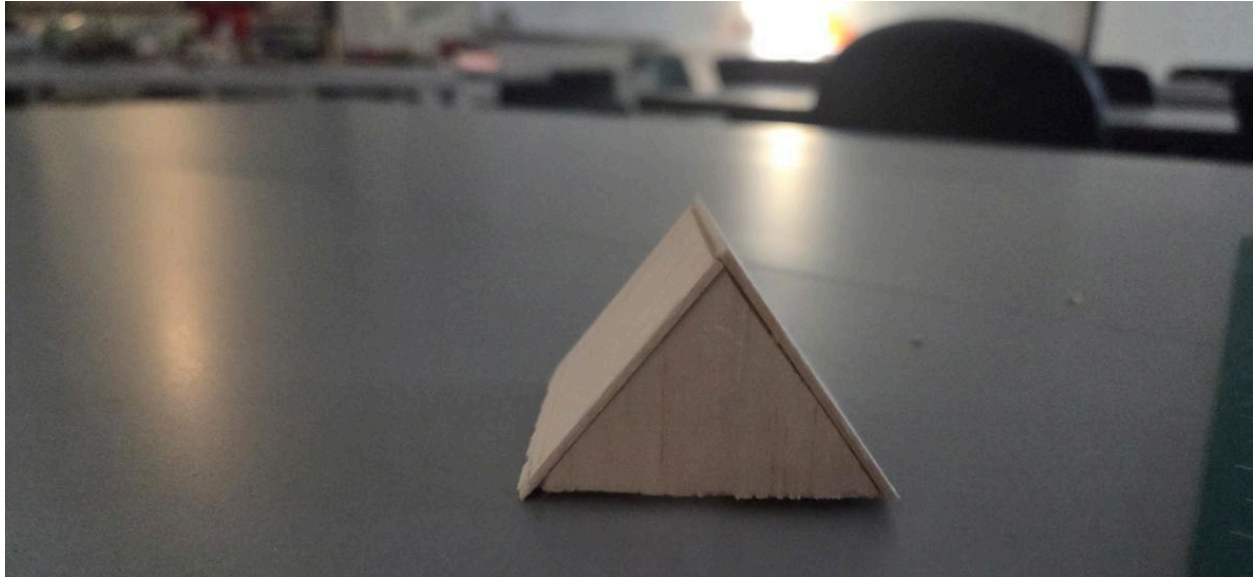

Figure 17: Rear View of Yoga Tent

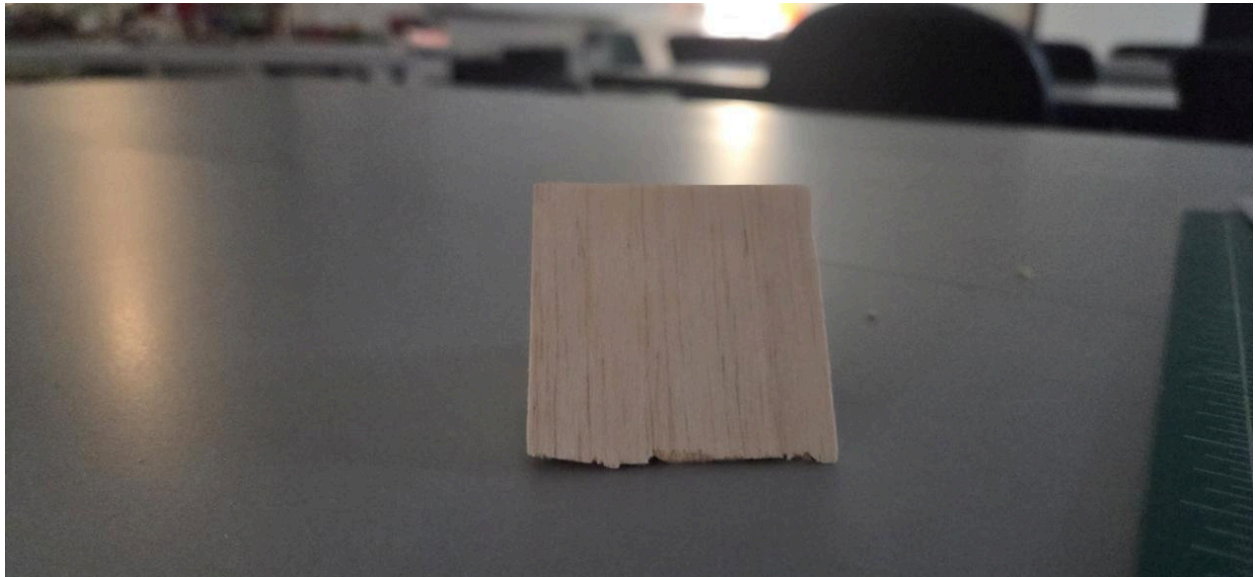

Figure 18: Left Side View of Yoga Tent

#### Appendix 4: Barndominium

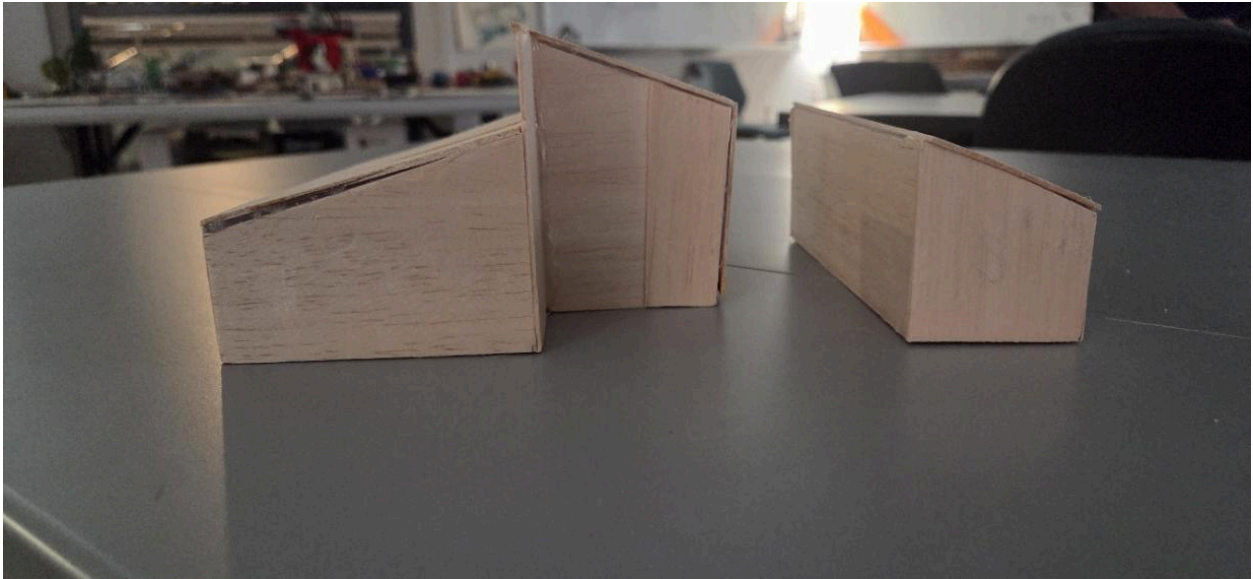

Figure 19: View 1 of Barndominium

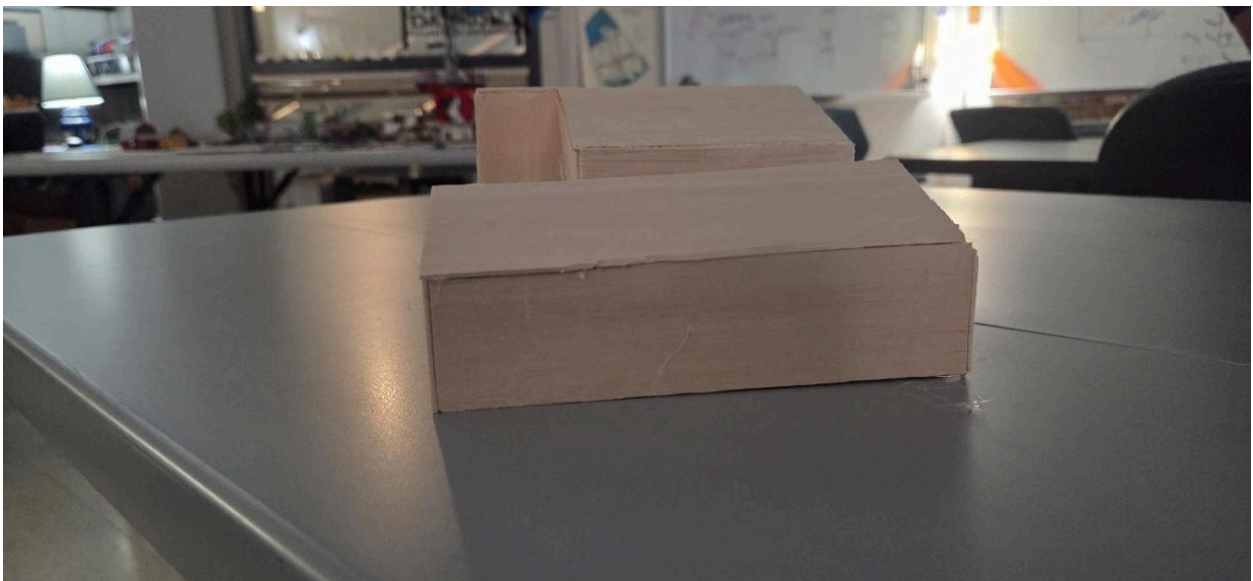

Figure 20: View 2 of Barndominium

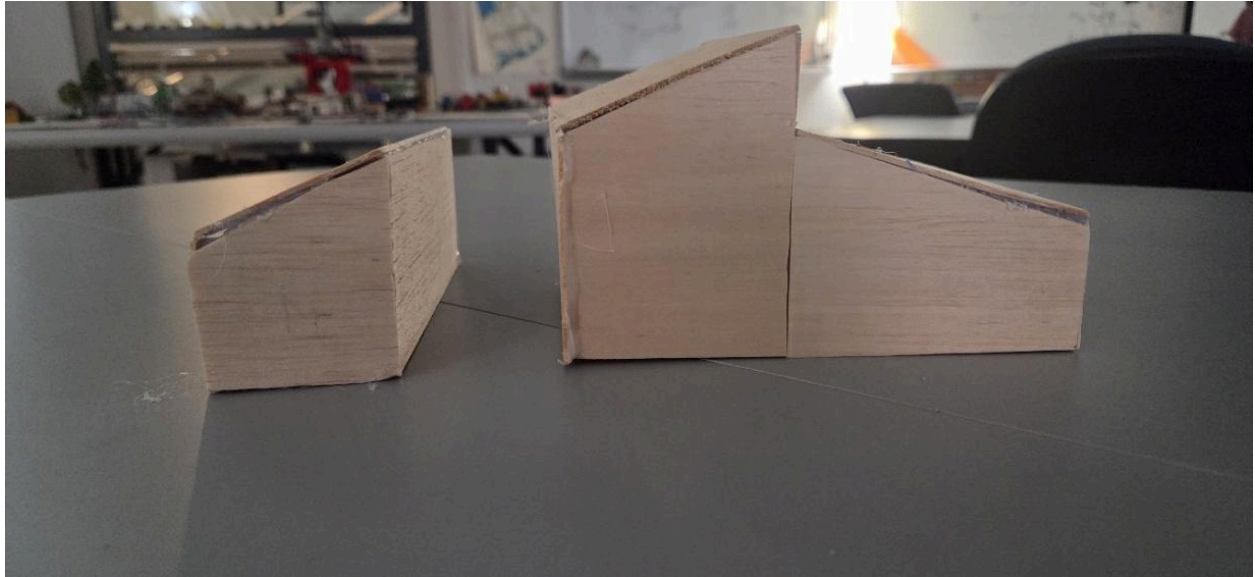

Figure 21: View 3 of Barndominium

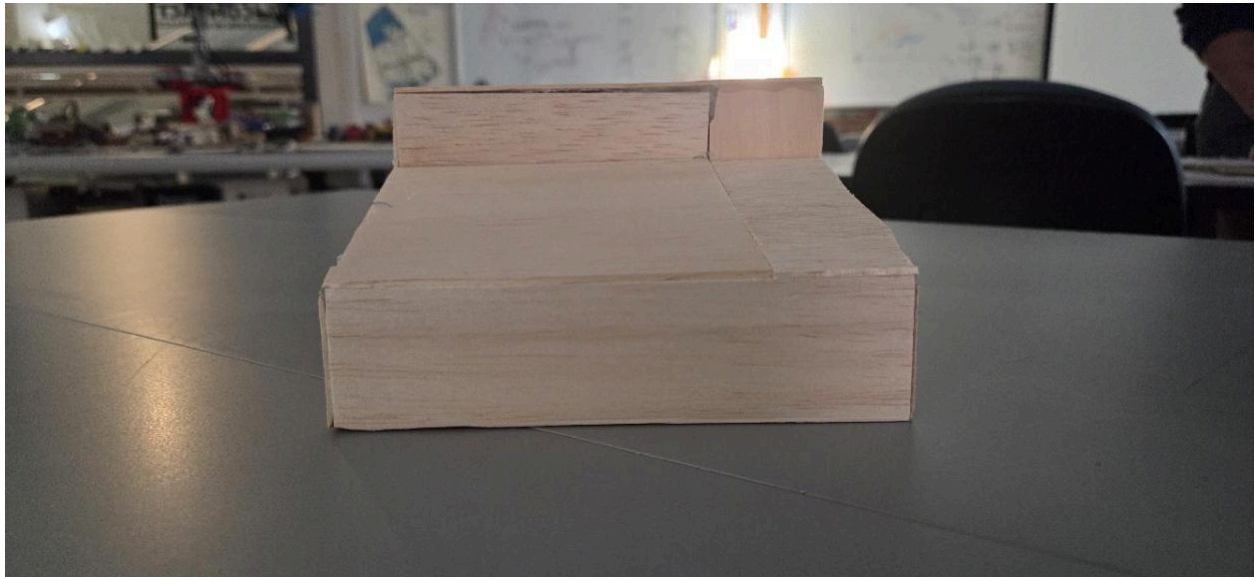

Figure 22: View 4 of Barndominium



## Appendix 5: Boat House

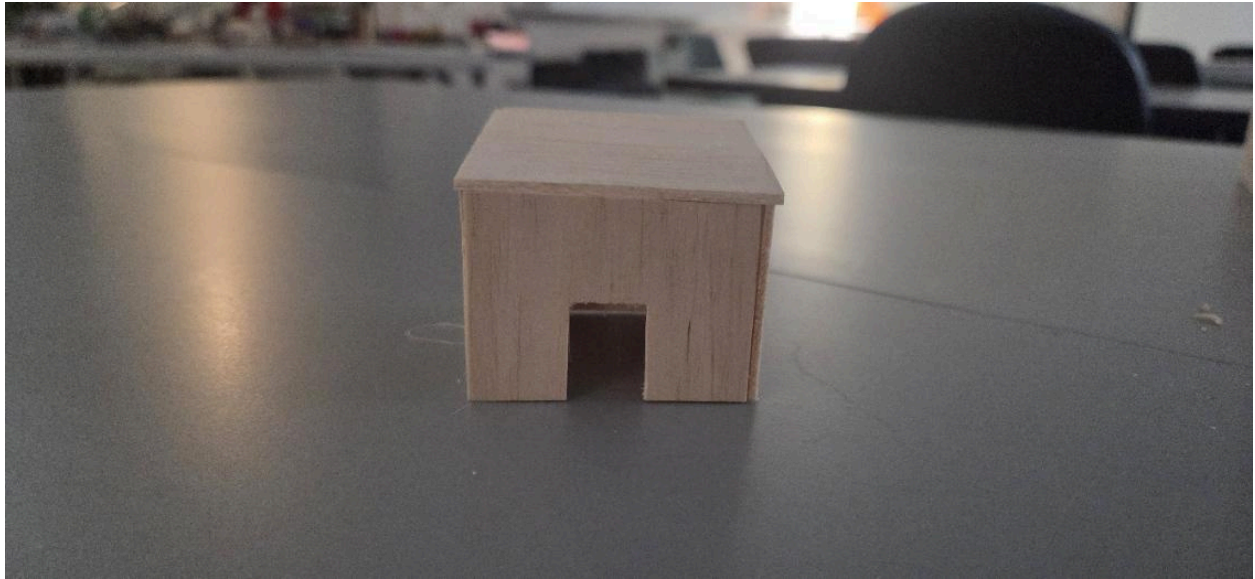

Figure 23: Front View of Boat House

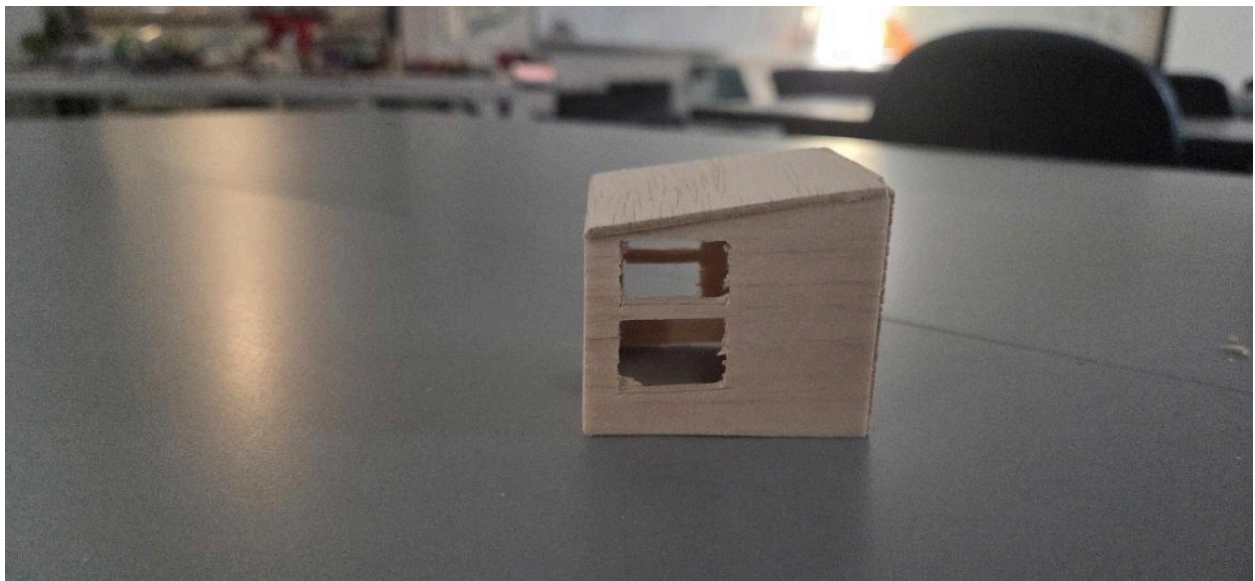

Figure 24: Right Side View of Boat House

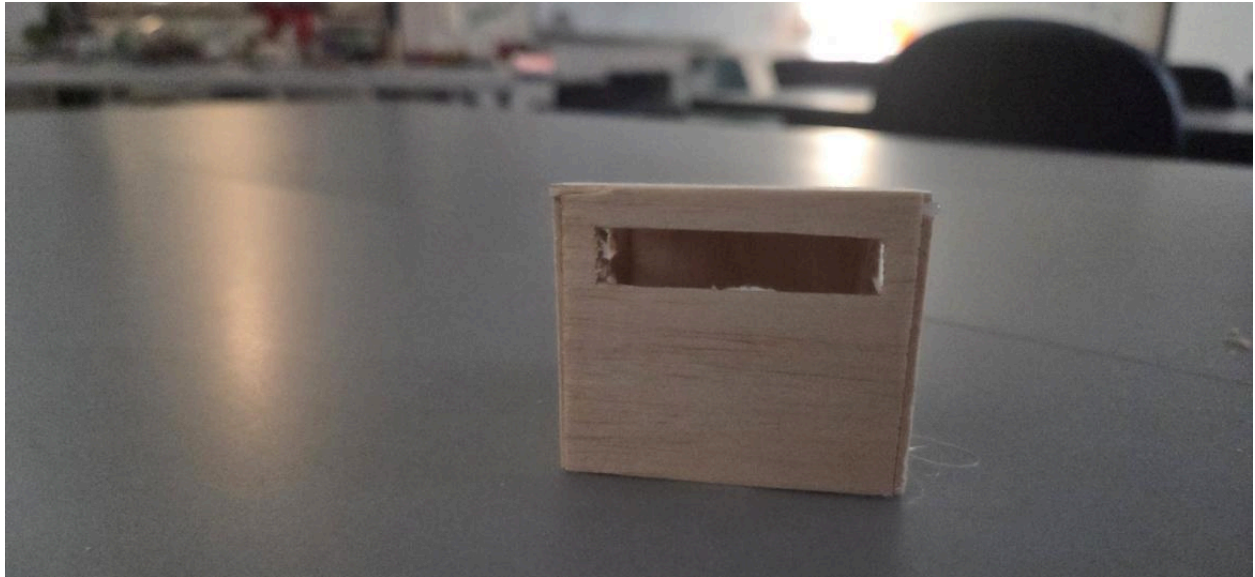

Figure 25: Rear View of Boat House

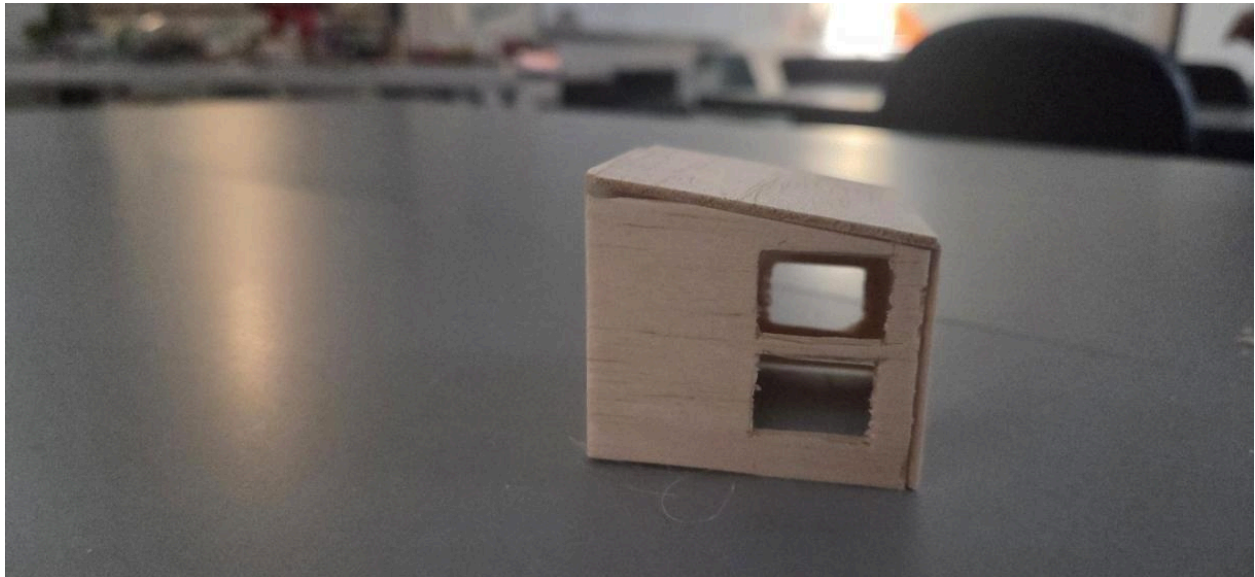

Figure 26: Left Side of Boat House



## Appendix 6: Green House/Dining Room

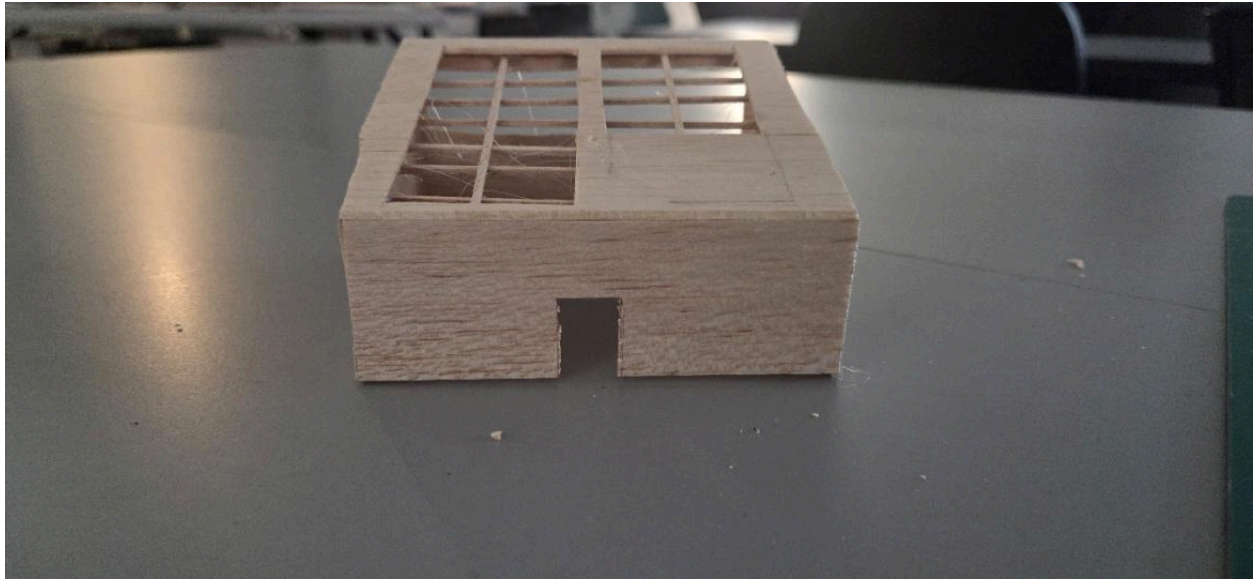

Figure 27: Front View of Green House/Dining Room

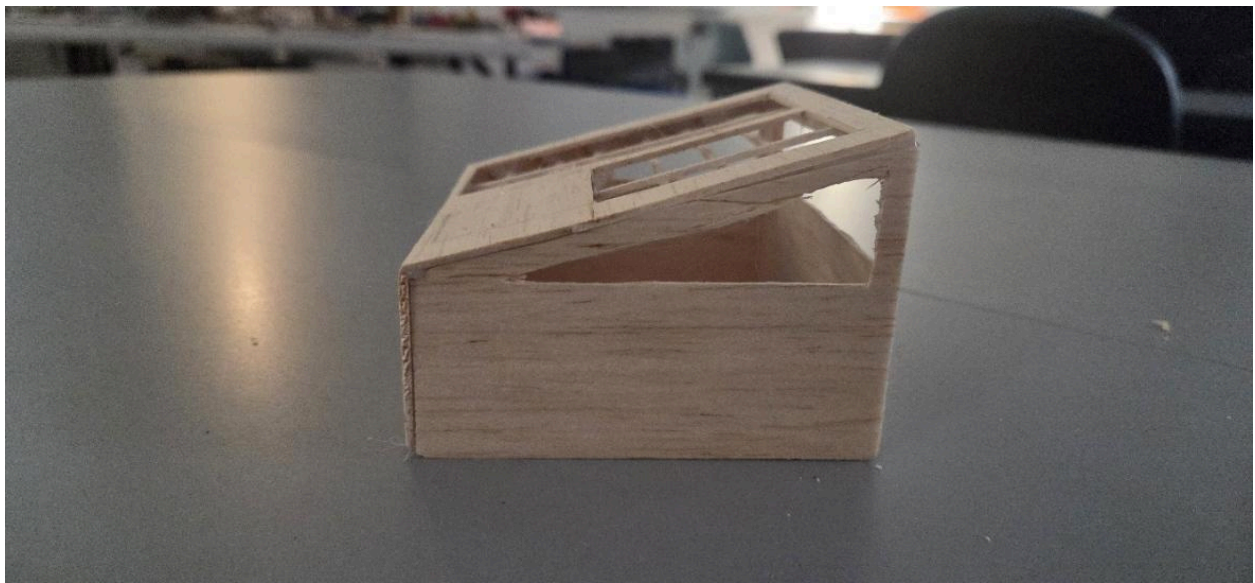

Figure 28: Right Side View of Green House/Dining Room





Figure 29: Rear View of Green House/Dining Room

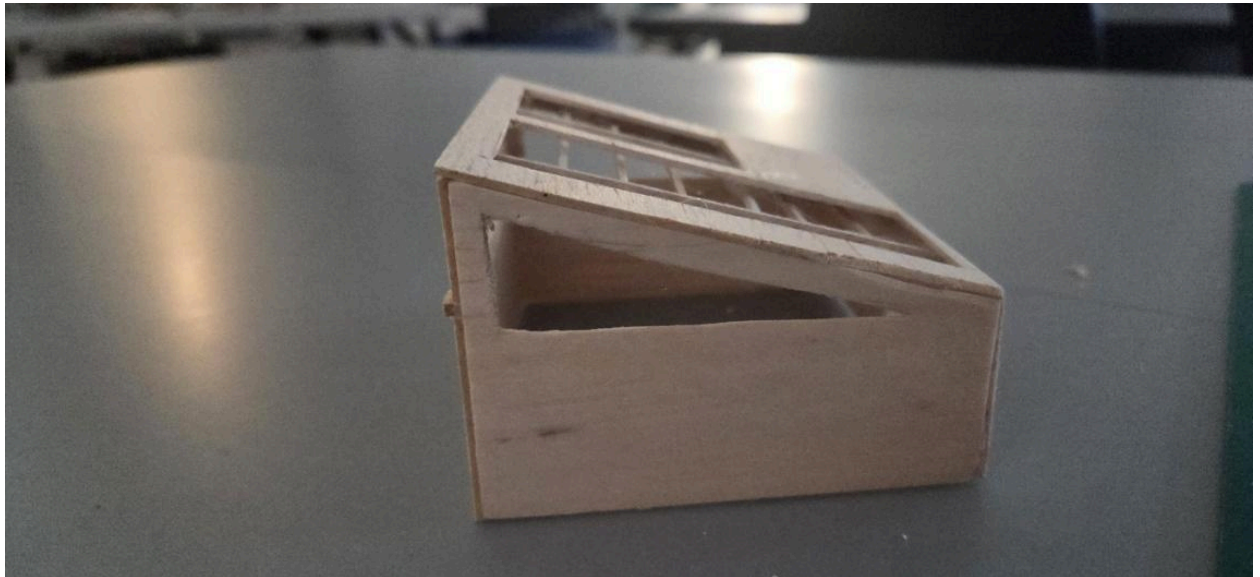

Figure 30: Left Side View of Green House/Dining Room



Figure 31: Top View of Green House/Dining Room

## Appendix 7: Upscale Horse Barn

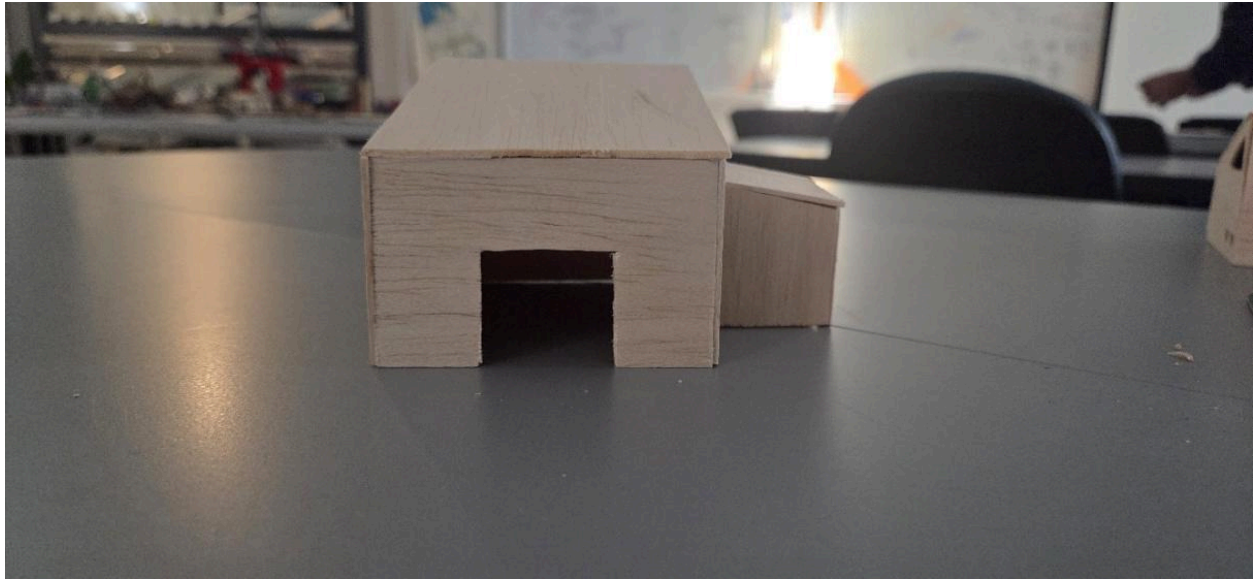

Figure 32: Front View of Upscale Horse Barn

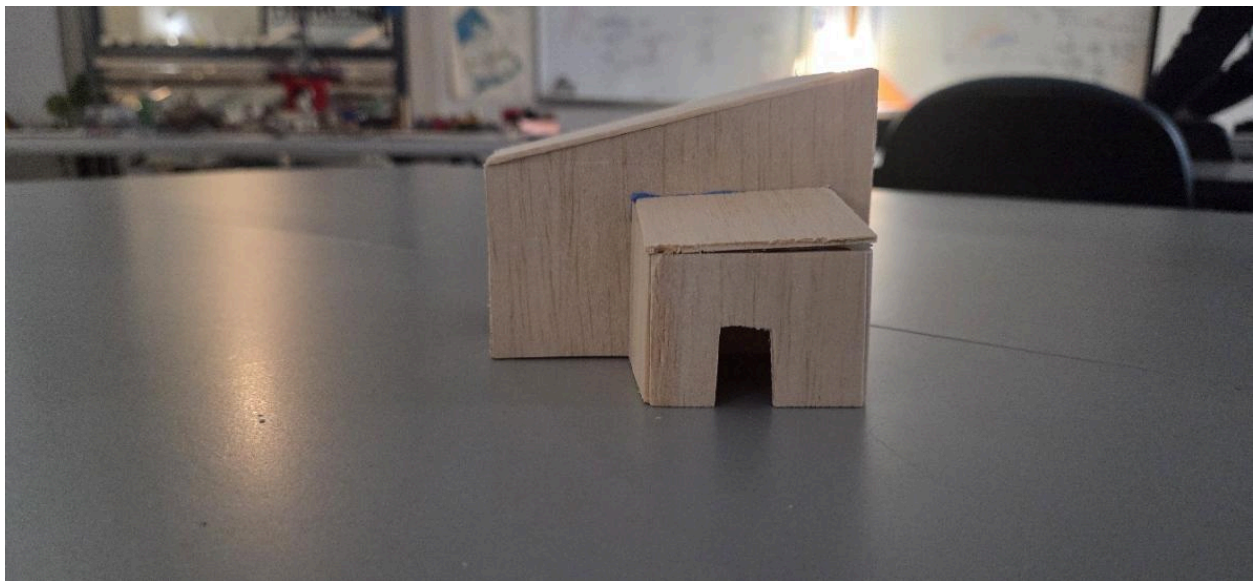

Figure 33: Right Side View of Upscale Horse Barn



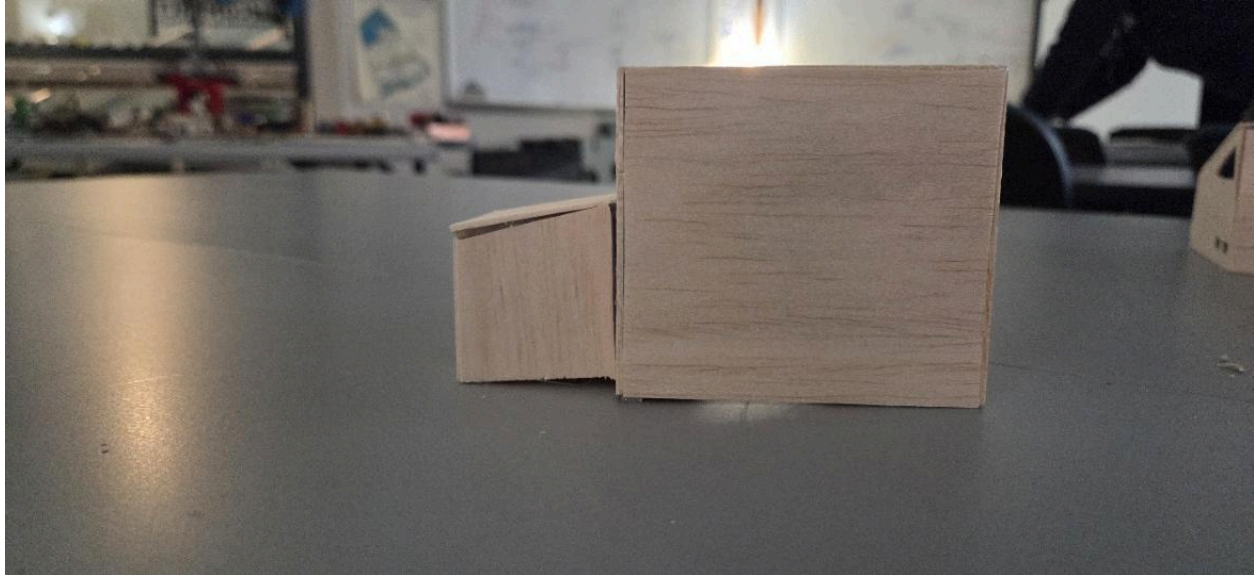

Figure 34: Rear View of Upscale Horse Barn

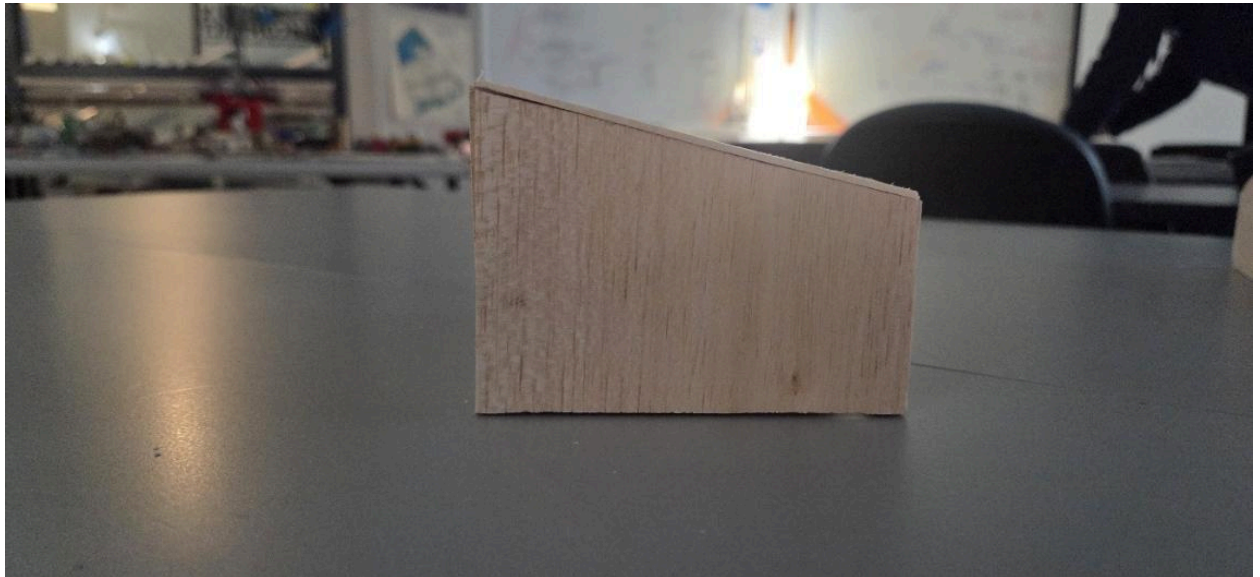

Figure 35: Left Side View of Upscale Horse Barn